



125 OMEGA - P45



104 OMEGA - D45



125 OMEGA - Frost 030

descrição description ·

- Luminária de encastrar com corpo em perfil de alumínio disponível em dois acabamentos distintos – branco mate RAL 9003 e anodizado natural mate;
- Equipada com reflectores parabólicos, em versões de alumínio mate ou brilhante com passo 45 ou equipada com difusor em policarbonato frost 030 com superfície anti-reflexo;
- A utilização de reflectores de alumínio torna esta luminária ideal para escritórios ou ambientes semelhantes com estações de trabalho com computadores;
- A combinação de excelente rendimento luminoso e baixo consumo de energia é ideal para iluminação de escritórios onde se exija elevada performance;
- A utilização de difusor em policarbonato frost 030 permite realizar linhas contínuas com uma excelente uniformidade de luz. O sistema de clipagem frontal do difusor permite o acesso às lâmpadas de uma forma rápida e garante um índice de protecção superior (IP43);
- Inclui conjunto de acessórios de fixação.

- Recessed aluminium profile luminaire available with two finishes: RAL 9003 matt white and natural matt anodised;
- Matt or mirrorbrite pitch 45 aluminium parabolic louvres or frost 030 polycarbonate diffuser with anti-glare surface;
- The aluminium reflector louvres option is suitable for offices or similar environments with DSE (Display Screen Equipment) workstations;
- The combination of excellent light output and low energy consumption, makes it ideal for office lighting where the highest level of performance is required;
- Frost 030 polycarbonate diffuser ensures higher light uniformity on continuous light lines. Quick snap push mount diffuser system ensures quick lamp maintenance and a higher degree of protection (IP43);
- Mounting accessory set is included.

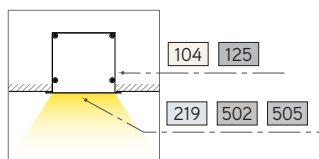

pormenores details ·

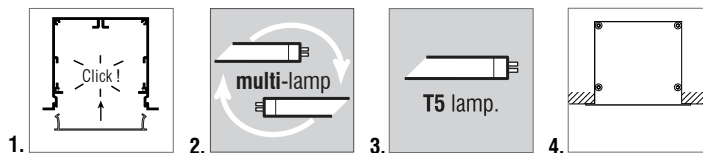

1. Sistema de clipagem rápida do difusor permite grande facilidade de manutenção da lâmpada . Quick snap push mount diffuser system ensures easy lamp maintenance
2. Balastro electrónico multi-lâmpada nas versões DIM e DALI . Dim and DALI versions with multi-lamp electronic control gear
3. Aparelho desenvolvido para a tecnologia de lâmpadas T5. Lâmpada não incluída . Specially designed for the T5 lamp technology. Lamp not included
4. Aplicação com aba à vista . Concealed false-ceiling profile

acabamento finishing ·

- 104 Branco mate RAL 9003 . RAL 9003 matt white
- 125 Alumínio anodizado natural mate . Natural matt anodised aluminium

perfis de alumínio - aluminium profiles

simbologia symbols ·



difusor diffuser ·

	Designação . Name	IP	IK	°C
	219 Policarbonato frost 030 . <i>Frost 030 polycarbonate</i>	IP20 geral	IP43 óptica	IK07

advertência warning ·

- A constituição molecular dos difusores em PC (polycarbonato) permite-lhes ter uma boa resistência ao choque (IK) e uma boa resistência à chama e à inflamação (resistência ao fio incandescente 850°C), no entanto têm uma moderada resistência aos U.V (ultravioleta) em particular os difusores opalinos. Por outro lado, verifica-se que os difusores PMMA (metacrilato) têm uma resistência moderada ao choque e ao fogo (resistência ao fio incandescente 650°C), mas uma boa resistência aos U.V. *The molecular constitution of the PC (polycarbonate) diffusers allows them to have a good impact resistance (IK) and a good resistance to flame and ignition (850°C glow-wire resistance), however they have a moderate resistance to UV (ultra-violet), particularly opal diffusers. On the other hand, PMMA (methacrylate) diffusers have a moderate impact and flame resistance (650°C glow-wire resistance), but a good U.V. resistance.*

reflectores louvres ·

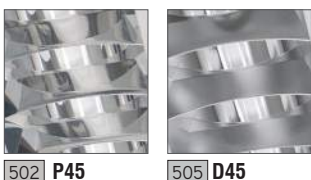

Designação . Name	IP	IK	°C
502 Reflector parabólico em alumínio brilhante (passo 45) . <i>Mirrorbrite parabolic aluminium louvre (pitch 45)</i>	IP20	IK07	960°C
505 Reflector parabólico em alumínio mate anodizado (passo 45) . <i>Matt anodised aluminium parabolic louvre (pitch 45)</i>			

opções options ·

- HF** - Balastro Electrónico . *High Frequency Electronic Control Gear*
- DIM** - Balastro Electrónico com Regulação do Fluxo Luminoso . *With High Frequency Electronic Dimming Control Gear.*
- DALI** (Digital Addressable Lighting Interface) - Com Balastro digital compatível com DALI . *With digital DALI-compatible ballast.*

extras standard extras ·

Designação . Name	Cod.
KIT 1H - Módulo Emergência 1 hora . <i>1 hour Emergency</i>	35.00.001.01.16
KIT 3H - Módulo Emergência 3 horas . <i>3 hours Emergency</i>	35.00.002.01.11

125 Alumínio anodizado natural mate . *Natural matt anodised aluminium*

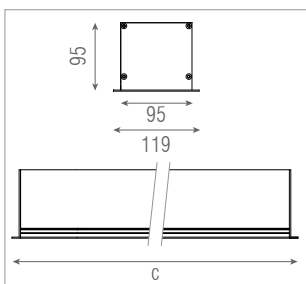

OMEGA - Polycarbonato frost 030 . *Frost 030 polycarbonate*

W		(mm) C	kg	(dm³)	±1 (mm)	Kit 1H	Kit 3H	HF	DIM	DALI
1x14W	G5	601	1,700	17,60	105x585	-	-	33.41.40.114018	33.41.40.114019	33.41.40.114020
1x21W	G5	901	2,300	26,40	105x885	-	-	33.41.40.121015	33.41.40.121016	33.41.40.121017
1x24W	G5	601	1,700	17,60	105x585	-	-	33.41.40.124010	33.41.40.114019	33.41.40.114020
1x28W	G5	1201	3,000	35,10	105x1185	•	-	33.41.40.128024	33.41.40.128025	33.41.40.128026
1x35W	G5	1501	3,600	43,90	105x1485	•	•	33.41.40.135026	33.41.40.135027	33.41.40.135028
1x39W	G5	901	2,300	26,40	105x885	-	-	33.41.40.139014	33.41.40.121016	33.41.40.121017
1x49W	G5	1501	3,600	43,90	105x1485	•	•	33.41.40.149027	33.41.40.135027	33.41.40.135028
1x54W	G5	1201	3,000	35,10	105x1185	•	-	33.41.40.154029	33.41.40.128025	33.41.40.128026
1x80W	G5	1501	3,600	43,90	105x1485	•	•	33.41.40.180025	33.41.40.135027	33.41.40.135028

Frost 030



OMEGA - Policarbonato frost 030 . Frost 030 polycarbonate

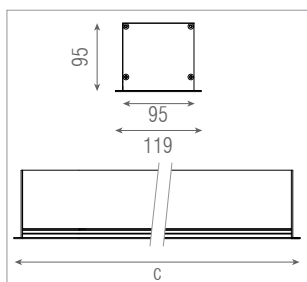

W		(mm) C	kg	(dm ³)	±1 (mm)	Kit 1H	Kit 3H	HF	DIM	
2x(1x28W)	G5	2268	5,800	66,30	105x2256	•	•	33.41.40.228027	33.41.40.228028	33.41.40.228029
2x(1x35W)	G5	2868	7,000	83,90	105x2856	•	•	33.41.40.235033	33.41.40.235034	33.41.40.235035
2x(1x49W)	G5	2868	7,000	83,90	105x2856	•	•	33.41.40.249045	33.41.40.235034	33.41.40.235035
2x(1x54W)	G5	2268	5,800	66,30	105x2256	•	•	33.41.40.254047	33.41.40.228028	33.41.40.228029
2x(1x80W)	G5	2868	7,000	83,90	105x2856	•	•	33.41.40.280041	33.41.40.235034	33.41.40.235035



OMEGA - Policarbonato frost 030 . Frost 030 polycarbonate

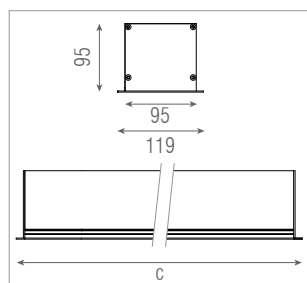

W		(mm) C	kg	(dm ³)	±1 (mm)	Kit 1H	Kit 3H	HF	DIM	
2x14W	G5	601	1,900	8,60	105x585	-	-	33.41.40.214010	33.41.40.214009	33.41.40.214008
2x21W	G5	901	2,500	12,80	105x885	-	-	33.41.40.221018	33.41.40.221019	33.41.40.221020
2x24W	G5	601	1,900	8,60	105x585	-	-	33.41.40.224009	33.41.40.214009	33.41.40.214008
2x28W	G5	1201	3,200	17,00	105x1185	•	-	33.41.40.228040	33.41.40.228041	33.41.40.228042
2x35W	G5	1501	3,800	21,21	105x1485	•	•	33.41.40.235049	33.41.40.235050	33.41.40.235051
2x39W	G5	901	2,500	12,80	105x885	-	-	33.41.40.239022	33.41.40.221019	33.41.40.221020
2x49W	G5	1501	3,800	21,21	105x1485	•	•	33.41.40.249046	33.41.40.235050	33.41.40.235051
2x54W	G5	1201	3,200	17,00	105x1185	•	-	33.41.40.254048	33.41.40.228041	33.41.40.228042
2x80W	G5	1501	3,800	21,21	105x1485	•	•	33.41.40.280042	33.41.40.235050	33.41.40.235051



OMEGA - Policarbonato frost 030 . Frost 030 polycarbonate

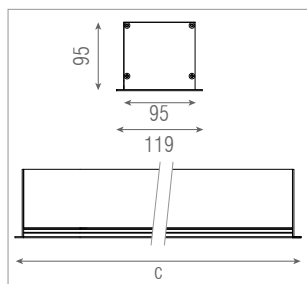

W		(mm) C	kg	(dm ³)	±1 (mm)	Kit 1H	Kit 3H	HF	DIM	
2x(2x28W)	G5	2473	6,510	72,30	105x2461	•	•	33.41.40.428023	33.41.40.428024	33.41.40.428025
2x(2x35W)	G5	3073	7,710	89,90	105x3061	•	•	33.41.40.435020	33.41.40.435019	33.41.40.435018
2x(2x49W)	G5	3073	7,710	89,90	105x3061	•	•	33.41.40.449024	33.41.40.435019	33.41.40.435018
2x(2x54W)	G5	2473	6,510	72,30	105x2461	•	•	33.41.40.454026	33.41.40.428024	33.41.40.428025
2x(2x80W)	G5	3073	7,710	89,90	105x3061	•	•	33.41.40.480016	33.41.40.435019	33.41.40.435018



104 Branco mate RAL 9003 . RAL 9003 matt white

OMEGA - Policarbonato frost 030 . Frost 030 polycarbonate

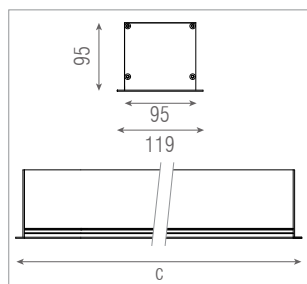

W		(mm) C	kg	(dm ³)	±1 (mm)	Kit 1H	Kit 3H	HF	DIM	
1x14W	G5	601	1,700	17,60	105x585	-	-	33.41.40.114012	33.41.40.114013	33.41.40.114014
1x21W	G5	901	2,300	26,40	105x885	-	-	33.41.40.121030	33.41.40.121029	33.41.40.121028
1x24W	G5	601	1,700	17,60	105x585	-	-	33.41.40.124020	33.41.40.114013	33.41.40.114014
1x28W	G5	1201	3,000	35,10	105x1185	•	-	33.41.40.128027	33.41.40.128028	33.41.40.128029
1x35W	G5	1501	3,600	43,90	105x1485	•	•	33.41.40.135020	33.41.40.135021	33.41.40.135022
1x39W	G5	901	2,300	26,40	105x885	-	-	33.41.40.139020	33.41.40.121029	33.41.40.121028
1x49W	G5	1501	3,600	43,90	105x1485	•	•	33.41.40.149036	33.41.40.135021	33.41.40.135022
1x54W	G5	1201	3,000	35,10	105x1185	•	-	33.41.40.154042	33.41.40.128028	33.41.40.128029
1x80W	G5	1501	3,600	43,90	105x1485	•	•	33.41.40.180026	33.41.40.135021	33.41.40.135022

Frost 030



OMEGA - Policarbonato frost 030 . Frost 030 polycarbonate

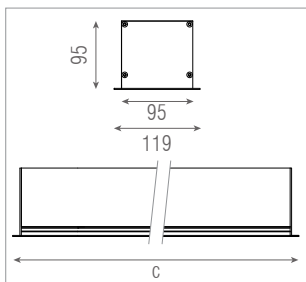

W		(mm) C	kg	(dm ³)	±1 (mm)	Kit 1H	Kit 3H	HF	DIM	
2x(1x28W)	G5	2268	5,800	66,30	105x2256	•	•	33.41.40.228030	33.41.40.228031	33.41.40.228032
2x(1x35W)	G5	2868	7,000	83,90	105x2856	•	•	33.41.40.235073	33.41.40.235074	33.41.40.235075
2x(1x49W)	G5	2868	7,000	83,90	105x2856	•	•	33.41.40.249066	33.41.40.235074	33.41.40.235075
2x(1x54W)	G5	2268	5,800	66,30	105x2256	•	•	33.41.40.254074	33.41.40.228031	33.41.40.228032
2x(1x80W)	G5	2868	7,000	83,90	105x2856	•	•	33.41.40.280048	33.41.40.235074	33.41.40.235075



OMEGA - Policarbonato frost 030 . Frost 030 polycarbonate

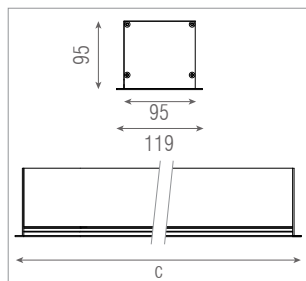

W		(mm) C	kg	(dm ³)	±1 (mm)	Kit 1H	Kit 3H	HF	DIM	
2x14W	G5	601	1,900	8,60	105x585	-	-	33.41.40.214017	33.41.40.214018	33.41.40.214019
2x21W	G5	901	2,500	12,80	105x885	-	-	33.41.40.221025	33.41.40.221026	33.41.40.221027
2x24W	G5	601	1,900	8,60	105x585	-	-	33.41.40.224012	33.41.40.214018	33.41.40.214019
2x28W	G5	1201	3,200	17,00	105x1185	•	-	33.41.40.228050	33.41.40.228052	33.41.40.228051
2x35W	G5	1501	3,800	21,21	105x1485	•	•	33.41.40.235076	33.41.40.235077	33.41.40.235078
2x39W	G5	901	2,500	12,80	105x885	-	-	33.41.40.239025	33.41.40.221026	33.41.40.221027
2x49W	G5	1501	3,800	21,21	105x1485	•	•	33.41.40.249063	33.41.40.235077	33.41.40.235078
2x54W	G5	1201	3,200	17,00	105x1185	•	-	33.41.40.254058	33.41.40.228052	33.41.40.228051
2x80W	G5	1501	3,800	21,21	105x1485	•	•	33.41.40.280044	33.41.40.235077	33.41.40.235078



OMEGA - Policarbonato frost 030 . Frost 030 polycarbonate

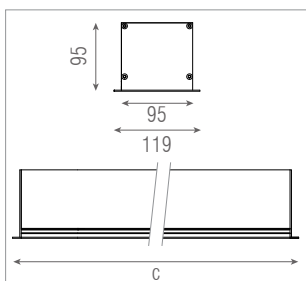

W		(mm) C	kg	(dm ³)	±1 (mm)	Kit 1H	Kit 3H	HF	DIM	
2x(2x28W)	G5	2473	6,510	72,30	105x2461	•	•	33.41.40.428050	33.41.40.428051	33.41.40.428052
2x(2x35W)	G5	3073	7,710	89,90	105x3061	•	•	33.41.40.435038	33.41.40.435039	33.41.40.435040
2x(2x49W)	G5	3073	7,710	89,90	105x3061	•	•	33.41.40.449028	33.41.40.435039	33.41.40.435040
2x(2x54W)	G5	2473	6,510	72,30	105x2461	•	•	33.41.40.454037	33.41.40.428051	33.41.40.428052
2x(2x80W)	G5	3073	7,710	89,90	105x3061	•	•	33.41.40.480028	33.41.40.435039	33.41.40.435040



125 Alumínio anodizado natural mate . Natural matt anodised aluminium

OMEGA - Reflector parabólico em alumínio brilhante (passo 45) . Mirrorbrite parabolic aluminium louvre (pitch 45)

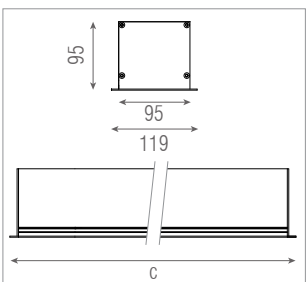

W		(mm) C	kg	(dm ³)	±1 (mm)	Kit 1H	Kit 3H	HF	DIM	
1x14W	G5	595	2,070	17,40	105x580	-	-	33.41.40.114021	33.41.40.114023	33.41.40.114015
1x21W	G5	895	2,670	26,17	105x880	-	-	33.41.40.121027	33.41.40.121025	33.41.40.121024
1x24W	G5	595	2,070	17,40	105x580	-	-	33.41.40.124017	33.41.40.114023	33.41.40.114015
1x28W	G5	1195	3,370	34,95	105x1180	•	-	33.41.40.128014	33.41.40.128020	33.41.40.128021
1x35W	G5	1495	3,970	43,72	105x1480	•	•	33.41.40.135023	33.41.40.135025	33.41.40.135029
1x39W	G5	895	2,670	26,17	105x880	-	-	33.41.40.139022	33.41.40.121025	33.41.40.121024
1x49W	G5	1495	3,970	43,72	105x1480	•	•	33.41.40.149040	33.41.40.135025	33.41.40.135029
1x54W	G5	1195	3,370	34,95	105x1180	•	-	33.41.40.154040	33.41.40.128020	33.41.40.128021
1x80W	G5	1495	3,970	43,72	105x1480	•	•	33.41.40.180030	33.41.40.135025	33.41.40.135029

P45



OMEGA - Reflector parabólico em alumínio brilhante (passo 45) . *Mirrorbrite parabolic aluminium louvre (pitch 45)*

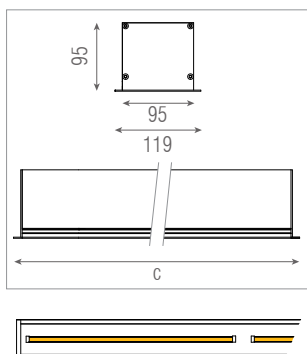

W		(mm) C	kg	(dm ³)	±1 (mm)	Kit 1H	Kit 3H	HF	DIM	
2x(1x28W)	G5	2366	6,540	69,20	105x2351	•	•	33.41.40.228068	33.41.40.228069	33.41.40.228070
2x(1x35W)	G5	2966	7,740	86,58	105x2951	•	•	33.41.40.235036	33.41.40.235037	33.41.40.235038
2x(1x49W)	G5	2966	7,740	86,58	105x2951	•	•	33.41.40.249069	33.41.40.235037	33.41.40.235038
2x(1x54W)	G5	2366	6,540	69,20	105x2351	•	•	33.41.40.254070	33.41.40.228069	33.41.40.228070
2x(1x80W)	G5	2966	7,740	86,58	105x2951	•	•	33.41.40.280051	33.41.40.235037	33.41.40.235038

104 Branco mate RAL 9003 . RAL 9003 matt white

OMEGA - Reflector parabólico em alumínio brilhante (passo 45) . *Mirrorbrite parabolic aluminium louvre (pitch 45)*

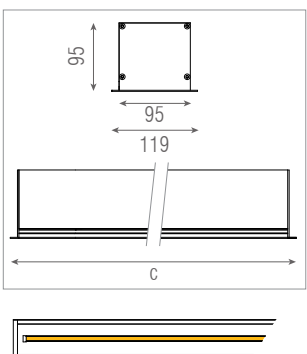

W		(mm) C	kg	(dm ³)	±1 (mm)	Kit 1H	Kit 3H	HF	DIM	
1x14W	G5	595	2,070	17,40	105x580	-	-	33.41.40.114006	33.41.40.114008	33.41.40.114009
1x21W	G5	895	2,670	26,17	105x880	-	-	33.41.40.121033	33.41.40.121035	33.41.40.121036
1x24W	G5	595	2,070	17,40	105x580	-	-	33.41.40.124019	33.41.40.114008	33.41.40.114009
1x28W	G5	1195	3,370	34,95	105x1180	•	-	33.41.40.128012	33.41.40.128016	33.41.40.128017
1x35W	G5	1495	3,970	43,72	105x1480	•	•	33.41.40.135014	33.41.40.135016	33.41.40.135017
1x39W	G5	895	2,670	26,17	105x880	-	-	33.41.40.139019	33.41.40.121035	33.41.40.121036
1x49W	G5	1495	3,970	43,72	105x1480	•	•	33.41.40.149037	33.41.40.135016	33.41.40.135017
1x54W	G5	1195	3,370	34,95	105x1180	•	-	33.41.40.154041	33.41.40.128016	33.41.40.128017
1x80W	G5	1495	3,970	43,72	105x1480	•	•	33.41.40.180027	33.41.40.135016	33.41.40.135017

P45



OMEGA - Reflector parabólico em alumínio brilhante (passo 45) . *Mirrorbrite parabolic aluminium louvre (pitch 45)*

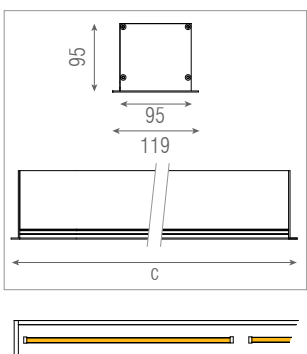

W		(mm) C	kg	(dm ³)	±1 (mm)	Kit 1H	Kit 3H	HF	DIM	
2x(1x28W)	G5	2366	6,540	69,20	105x2351	•	•	33.41.40.228021	33.41.40.228022	33.41.40.228023
2x(1x35W)	G5	2966	7,740	86,58	105x2951	•	•	33.41.40.235027	33.41.40.235028	33.41.40.235029
2x(1x49W)	G5	2966	7,740	86,58	105x2951	•	•	33.41.40.249067	33.41.40.235028	33.41.40.235029
2x(1x54W)	G5	2366	6,540	69,20	105x2351	•	•	33.41.40.254072	33.41.40.228022	33.41.40.228023
2x(1x80W)	G5	2966	7,740	86,58	105x2951	•	•	33.41.40.280049	33.41.40.235028	33.41.40.235029

125 Alumínio anodizado natural mate . Natural matt anodised aluminium

OMEGA - Reflector parabólico em alumínio mate anodizado (passo 45) . Matt anodised aluminium parabolic louvre (pitch 45)

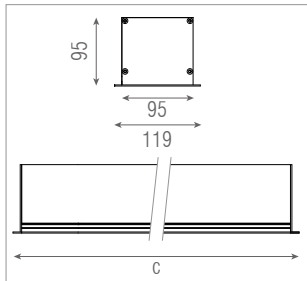

W		(mm) C	kg	(dm ³)	 ±1 (mm)	Kit 1H	Kit 3H	HF	DIM	
1x14W	G5	595	2,070	17,40	105x580	-	-	33.41.40.114022	33.41.40.114016	33.41.40.114017
1x21W	G5	895	2,670	26,17	105x880	-	-	33.41.40.121026	33.41.40.121031	33.41.40.121032
1x24W	G5	595	2,070	17,40	105x580	-	-	33.41.40.124016	33.41.40.114016	33.41.40.114017
1x28W	G5	1195	3,370	34,95	105x1180	•	-	33.41.40.128015	33.41.40.128022	33.41.40.128023
1x35W	G5	1495	3,970	43,72	105x1480	•	•	33.41.40.135024	33.41.40.135030	33.41.40.135031
1x39W	G5	895	2,670	26,17	105x880	-	-	33.41.40.139021	33.41.40.121031	33.41.40.121032
1x49W	G5	1495	3,970	43,72	105x1480	•	•	33.41.40.149039	33.41.40.135030	33.41.40.135031
1x54W	G5	1195	3,370	34,95	105x1180	•	-	33.41.40.154039	33.41.40.128022	33.41.40.128023
1x80W	G5	1495	3,970	43,72	105x1480	•	•	33.41.40.180029	33.41.40.135030	33.41.40.135031

D45



OMEGA - Reflector parabólico em alumínio mate anodizado (passo 45) . Matt anodised aluminium parabolic louvre (pitch 45)

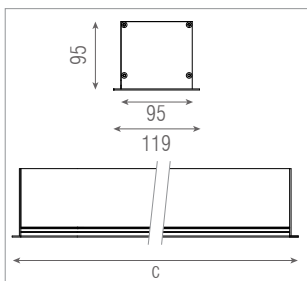

W		(mm) C	kg	(dm ³)	 ±1 (mm)	Kit 1H	Kit 3H	HF	DIM	
2x(1x28W)	G5	2366	6,540	69,20	105x2351	•	•	33.41.40.228065	33.41.40.228066	33.41.40.228067
2x(1x35W)	G5	2966	7,740	86,58	105x2951	•	•	33.41.40.235070	33.41.40.235071	33.41.40.235072
2x(1x49W)	G5	2966	7,740	86,58	105x2951	•	•	33.41.40.249070	33.41.40.235071	33.41.40.235072
2x(1x54W)	G5	2366	6,540	69,20	105x2351	•	•	33.41.40.254071	33.41.40.228066	33.41.40.228067
2x(1x80W)	G5	2966	7,740	86,58	105x2951	•	•	33.41.40.280052	33.41.40.235071	33.41.40.235072

104 Branco mate RAL 9003 . RAL 9003 matt white

OMEGA - Reflector parabólico em alumínio mate anodizado (passo 45) . Matt anodised aluminium parabolic louvre (pitch 45)

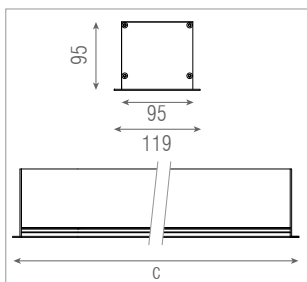

W		(mm) C	kg	(dm ³)	 ±1 (mm)	Kit 1H	Kit 3H	HF	DIM	
1x14W	G5	595	2,070	17,40	105x580	-	-	33.41.40.114007	33.41.40.114010	33.41.40.114011
1x21W	G5	895	2,670	26,17	105x880	-	-	33.41.40.121034	33.41.40.121037	33.41.40.121038
1x24W	G5	595	2,070	17,40	105x580	-	-	33.41.40.124018	33.41.40.114010	33.41.40.114011
1x28W	G5	1195	3,370	34,95	105x1180	•	-	33.41.40.128013	33.41.40.128018	33.41.40.128019
1x35W	G5	1495	3,970	43,72	105x1480	•	•	33.41.40.135015	33.41.40.135018	33.41.40.135019
1x39W	G5	895	2,670	26,17	105x880	-	-	33.41.40.139018	33.41.40.121037	33.41.40.121038
1x49W	G5	1495	3,970	43,72	105x1480	•	•	33.41.40.149038	33.41.40.135018	33.41.40.135019
1x54W	G5	1195	3,370	34,95	105x1180	•	-	33.41.40.154038	33.41.40.128018	33.41.40.128019
1x80W	G5	1495	3,970	43,72	105x1480	•	•	33.41.40.180028	33.41.40.135018	33.41.40.135019







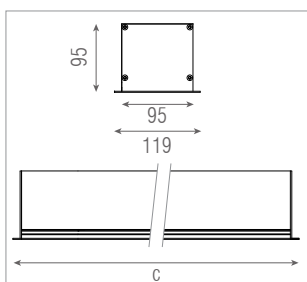





D45



OMEGA - Reflector parabólico em alumínio mate anodizado (passo 45) . Matt anodised aluminium parabolic louvre (pitch 45)



W		(mm) C	kg	(dm ³)	 ±1 (mm)	Kit 1H	Kit 3H	HF	DIM	
2x(1x28W)	G5	2366	6,540	69,20	105x2351	•	•	33.41.40.228024	33.41.40.228025	33.41.40.228026
2x(1x35W)	G5	2966	7,740	86,58	105x2951	•	•	33.41.40.235030	33.41.40.235031	33.41.40.235032
2x(1x49W)	G5	2966	7,740	86,58	105x2951	•	•	33.41.40.249068	33.41.40.235031	33.41.40.235032
2x(1x54W)	G5	2366	6,540	69,20	105x2351	•	•	33.41.40.254073	33.41.40.228025	33.41.40.228026
2x(1x80W)	G5	2966	7,740	86,58	105x2951	•	•	33.41.40.280050	33.41.40.235031	33.41.40.235032

	Saliente tecto <i>Ceiling surface</i>		Aplique parede <i>Wall surface</i>		Saliente chão <i>Floor surface</i>		De canto <i>Corner mounted</i>
	Encastrado tecto <i>Ceiling recessed</i>		Encastrado parede <i>Wall recessed</i>		Encastrado chão <i>Floor recessed</i>		De pé <i>Floor standing</i>
	Trimless tecto <i>Ceiling trimless</i>		Trimless parede <i>Wall trimless</i>		Suspenso tecto <i>Ceiling suspended</i>		De mesa <i>Table standing</i>



Lâmpada não incluída. *Lamp not included.*



Lâmpada incluída. *Lamp included.*



Marca de conformidade com as Normas Europeias do Comité Europeu de Normalização Electrotécnica (CENELEC), aplicável a todo o material eléctrico certificado pela CERTIF no âmbito do acordo CCA do CENELEC. *Reference symbol of compliance with the European Norms of the European Electrotechnical Standardization Committee (CENELEC) applied to every electrical material certified by CERTIF in accordance with the CCA of the CENELEC.*



ENEC - Marca comum europeia concedida no âmbito do Acordo ENEC, aplicável a todo o tipo de luminárias em conformidade com as normas da série EN 60 598. Marca reconhecida em todos os países subscritores do referido acordo. 04 - Numeração atribuída a Portugal. *ENEC - European common reference symbol granted in accordance with the ENEC Agreement, applicable to every type of luminaire within the Standards of the EN 60 598 series. Reference symbol recognized in all the countries that subscribed the referred agreement. 04 -Number assigned to Portugal.*



Produto projectado e fabricado em conformidade com a directiva comunitária 2004 / 108 / CE relativa à Compatibilidade Electromagnética e com a directiva comunitária 2006 / 95 / CE para equipamentos de Baixa Tensão. *Product designed and manufactured in accordance with the Council Directive 2004 / 108 / CE concerning the Electromagnetic Compatibility and the Council Directive 2006 / 95 / CE for Low-Tension equipment.*



Esta luminária não pode ser coberta com material isolante ou análogo. *Luminaire not suitable for covering with thermally insulating material.*



Fonte luminosa LED. *LED light source.*



Classe I - Isolamento principal e protecção por ligação à terra prevista nas partes metálicas acessíveis. *Class I - All the exposed metal parts are connected to one another and to the protective earth conductor.*

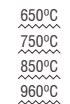

O ensaio é efectuado utilizando um fio de Ni-Cr incandescente aquecido a 650°C, 750°C, 850°C ou 960°C. *The test is made using nickel-chromium flow-wire heated to 650°C, 750°C, 850°C or 960°C.*



Classe II - Com isolamento principal e isolamento suplementar, mas sem meio de protecção por ligação à terra. *Class II - The luminaire is insulated in such a way that there are no exposed metal parts that can carry current. There is no protective earth conductor.*



Luminária protegida contra o arremesso de bolas, de acordo com especificado na norma DIN VDE 0710 part 13/05.81. *Luminaire safe to ball throwing in accordance with DIN VDE 0710 part 13/05.81 standard.*



Classe III - Previsto para alimentação em muita baixa tensão de segurança ($\leq 50V$). *Class III - Appliance designed to be supplied from a safety extra-low voltage power source.*



Dimensão do corte no tecto para encastrar luminária (tolerância em mm). *Cut-out dimension for recessed luminaires (tolerance in mm).*



Adaptável aos módulos standard dos tectos falsos. *Adaptable to the standard modules of the false ceilings.*



Casquilho / Suporte de lâmpada. *Lamp holder.*



O prefixo IP seguido de dois algarismos, indica a "resistência" oferecida pelo aparelho à penetração de corpos sólidos e líquidos, sendo que o primeiro algarismo identifica a protecção à entrada de elementos sólidos e o segundo aos líquidos. *The IP prefix followed by two figures indicates the "resistance" offered by the device to solid bodies and liquids penetration, the first figure being representative of the protection to solid bodies penetration and the second to liquids.*



Peso unitário aproximado sem embalagem (em Kg). *Unit approximate weight without package (specified in Kg).*



Volume unitário com embalagem (em dm³). *Unit approximate volume with package. Specified in dm³.*



Dimensões em mm. *Dimensions in mm.*



Índice Resistência Mecânica - Grau de resistência dos invólucros das luminárias a impactos mecânicos externos, definidos pela norma EN 62262. *Mechanical Resistance Classes - Resistance degree of the luminaires envelope against external mechanical impacts, defined by EN 62262 standards.*



Distância mínima dos objectos iluminados (em metros). *Minimum distance between the lit object and the luminaire (in metres).*